

A DEVELOPMENT BY
TRICONNA REAL ESTATE

SKYVIEW ESTATE



A modern, multi-story residential building with a prominent balcony featuring large glass windows and a glass railing. The building has a contemporary design with light-colored wood paneling and dark accents. The sky is clear and blue.

SKY VIEW ESTATE

Transcend into your dream lifestyle at Sky View Estate Umunyagu, Rivers State, Nigeria. SKY VIEW ESTATE is a perfect estate for residential and commercial purposes. Making it a strategic location for luxurious residential living and an ideal destination for thriving business

AMENITIES



GOOD
DRAINAGE



GOOD ROAD
ACCESS



GOOD
ELECTRICITY



24/7
SECURITY

FACILITIES



GREEN AREAS



PLAYGROUND



HEALTHCARE
FACILITIES

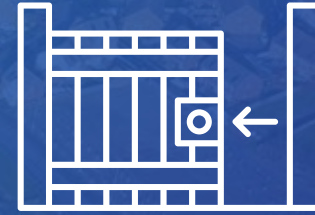

GATE HOUSE



PAYMENT PLANS

RESIDENTIAL PLOT

N3M

OUTRIGHT PAYMENT

DURATION	AMOUNT	INITIAL DEPOSIT
0-3 MONTH	3,000,000	500,000
0-6 MONTHS	3,100,000	500,000
0-12 MONTHS	3,500,000	500,000

SKY VIEW LAYOUT PLAN

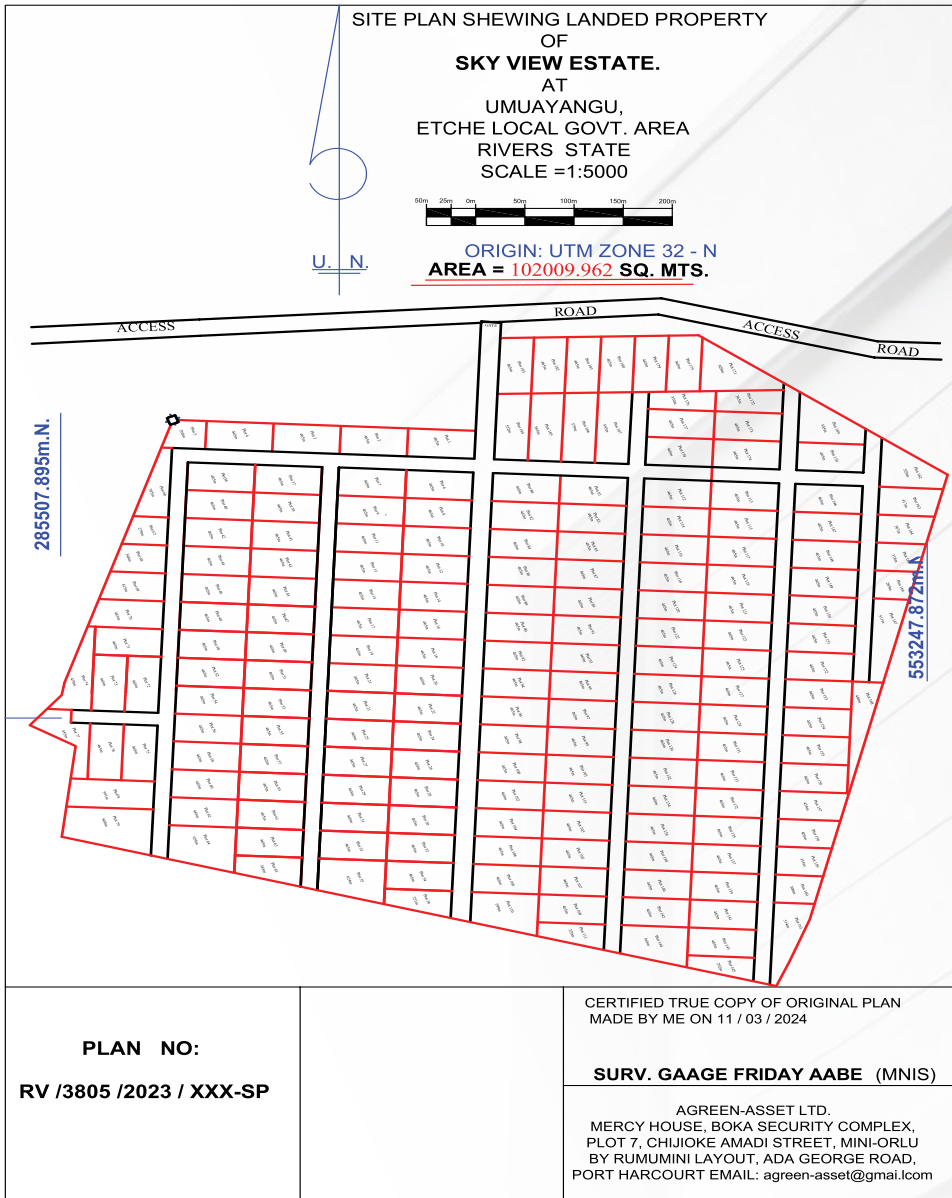

FAQS

Q: Where is SKY VIEW ESTATE located?

A: SKY VIEW ESTATE is situated 2 minutes drive away from Chokocho Junction on the major road, 3 minutes drive from Igwuruta market.

Q: What title document does the land carry?

A: SKY VIEW has a Deed of Conveyance and a Registered Survey Plan, and it is 100% free from any encumbrances and litigation.

Q: What is the nature and topography of SKY VIEW ESTATE?

A: SKY VIEW ESTATE is a 100% table dry land.

Q: What kind of infrastructure will be installed in the estate?

A: SKY VIEW ESTATE comes with the following features: Perimeter fencing, Electricity, Security, Drainage, a Gatehouse, and a Graded Internal Road Network

Q: Do I have to pay any additional fees after paying for the land?

A: There are no extra charges beyond the land price.

Q: Do I have to pay for the Survey and Deed of Conveyance?

A: No. You'll get a free Survey Plan and a Deed of Conveyance after making complete payment on your plot(s)

Q: What is the cost of a plot of land at SKY VIEW ESTATE?

A: A plot of land at SKY VIEW ESTATE is currently selling at N3,000,000 per plot for outright purchase.

Q: What is the plot size?

A: 465 sqm per plot. (50 by 100).

ABOUT

Triconna is a value-driven brand dedicated to providing you with the best real estate investment solutions that are habitable, affordable, sustainable, and tailored to your needs. Giving you optimal value for your investment.

We are passionately driven to turn the dream of affordable homes into a reality for the common man. Our vision inspires us every day to create innovative solutions, build stronger communities, and ensure that everyone has a place to call home.

OTHER PROPERTIES



**Achievers
Estate**

LISBON
HOUSING ESTATE II

SWISS GARDENS

CONTACT

 +234-916-000-5526, +234 916-000-5527.

 info@triconna.com  triconna.com



NO. 167A Ebufegha Plaza, Ada George, Port Harcourt.

   @triconna